



WARLAND BUSINESS PARK

11065-11235 KNOTT AVENUE CYPRESS, CA

AVAILABLE SPACE

(REVISED JUN. 20, 2018)



| ADDRESS | BLDG | SF | RATE (NNN) | COMMENTS |
|--------------|---------|---------|------------|--|
| 11065 Knottt | 1AB | ±14,024 | \$1.15 | 100% office, Knott Avenue frontage, 4:1 parking, Available 6/1/18. |
| 11075 Knott | 2B | ±7,940 | \$1.00 | 30% office, 2 GL doors, 4:1 parking, Available NOW. |
| 11075 Knott | 2C | ±9,893 | \$1.02 | 80% office, 1 GL door, 4:1 parking, Available NOW. |
| 11075 Knott | 2BC | ±17,833 | \$1.00 | 65% office (open and private), 3 GL doors, 4:1 parking, Available NOW. |
| 11095 Knott | 4DEFGHI | ±8,732 | \$1.02 | 70% office, corner location, 3 GL doors, 3.5:1 parking, Available 6/1/18. |
| 11145 Knott | 8ABC | ±6,530 | \$0.93 | 60% office, 3 GL doors, 5 private offices, 3.5:1 parking. Refurbishment Underway. Available NOW. |
| 11205 Knott | 11B | ±4,260 | \$1.02 | 100% office, corner location, 4:1 parking. Available NOW. |

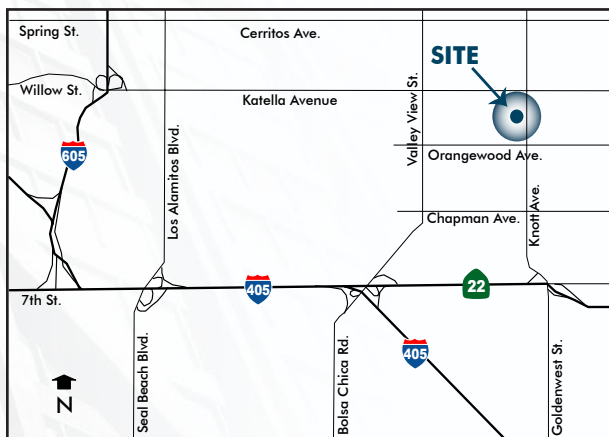

FEATURES:

- Award-Winning Design
- 13 Buildings Totaling 233,160 S.F./ On-Site Leasing Office
- See Reverse for Site Plan

FOR INFORMATION, PLEASE CONTACT:

BRIAN DEREVERE
 Lic. 00885755
 +1 714 371 9224
 brian.derevere@cbre.com

RYAN PETERSON
 Lic. 01336025
 +1 714 371 9212
 ryan.peterson@cbre.com

JB GREEN
 Lic. 01947400
 +1 714 371 9223
 john.green@cbre.com



WARLAND BUSINESS PARK

11065-11235 KNOTT AVENUE CYPRESS, CA

AVAILABLE SPACE

(REVISED JUN. 20, 2018)

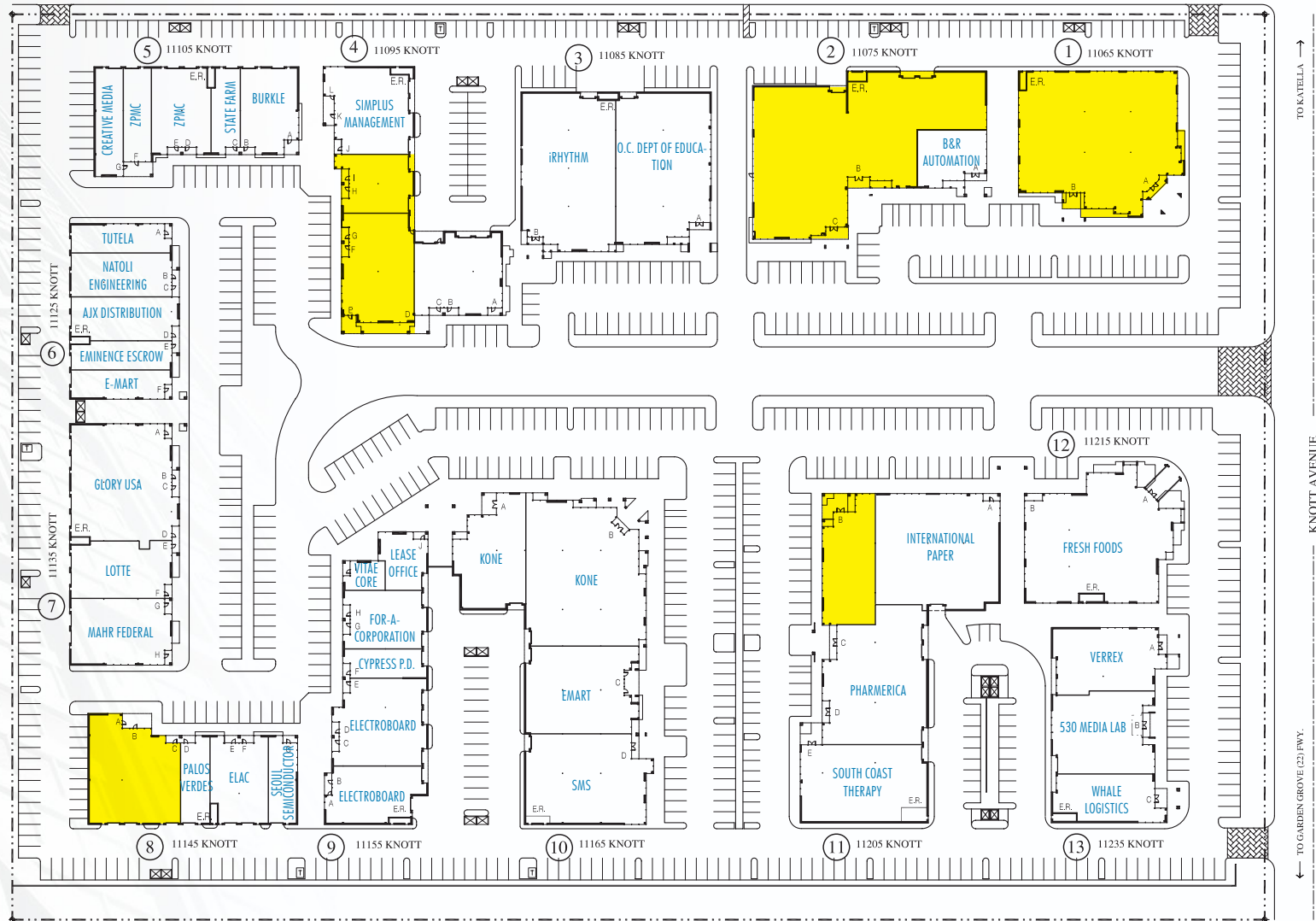

FOR INFORMATION
PLEASE CONTACT:

BRIAN DEREVERE
Lic. 00885755
+1 714 371 9224
brian.derevere@cbre.com

RYAN PETERSON
Lic. 01336025
+1 714 371 9212
ryan.peterson@cbre.com

JB GREEN
Lic. 01947400
+1 714 371 9223
john.green@cbre.com